

10' Retractable Stand

Setting Up Your Red Carpet Experience is Minutes Away!



10' RETRACTABLE STAND

OUR 10' RETRACTABLE STAND CAN FIT CUSTOM BACKDROPS UP TO 10' WIDE AND 10' HIGH.

KIT INCLUDES:



CONVERSION KIT

OUR CONVERSION KIT EXTENDS OUR 10' RETRACTABLE STAND TO FIT BACKDROPS UP TO 12' AND 14' WIDE.

CONVERSION KIT INCLUDES:



14' WIDE

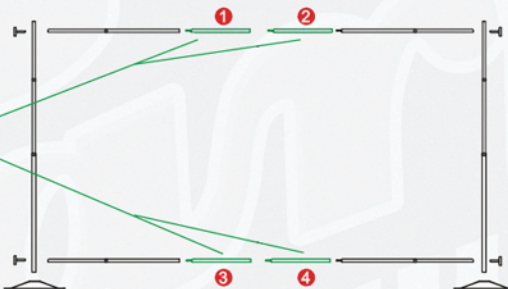

Assemble the telescopic uprights and the feet using the supplied screws and screwdriver.

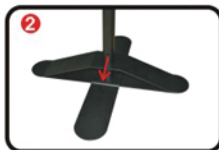

Align mounting holes to face the flat sides of the feet.



Assemble the top and bottom poles respectively. Top and bottom poles can be identified by stickers near shaped ends.

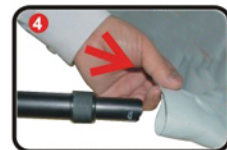

Slide the graphic over the loose ends of top and bottom poles as shown above.



Attach the top pole to one of the uprights as shown above, tighten up the thumb screw.



Tighten up the thumb screw to make sure the top and bottom poles are securely assembled.

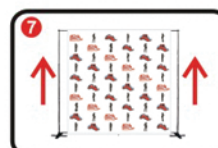

Adjust the height of the telescopic uprights to get good tension of the graphic.



Finished.